

**SWING GATE
OPERATOR**

ECLISTAR



INSTALLATION MANUAL

INDEX

1.0	General characteristics	pag.	2
1.1	Components	pag.	3
1.2	Technical features	pag.	3
1.3	Dimensions	pag.	3
1.4	Main component parts of a standard installation	pag.	4
1.5	Limits to use	pag.	6
2.0	Installing the gearmotor	pag.	7
3.0	Control panel	pag.	18
3.1	Assembling and fixing the casing	pag.	20
3.2	Control board and its functions – description	pag.	22
3.3	Electrical connections	pag.	23
3.4	Selecting functions	pag.	27
3.5	Adjusting functions	pag.	29
3.6	Checking endstops adjustments	pag.	30
3.7	Programming the radio code	pag.	31
3.8	Control LEDs' functions	pag.	32
3.9	Final operations	pag.	32
4.0	Warnings and precautions	pag.	33
5.0	Troubleshooting	pag.	33
6.0	Maintenance	pag.	34
7.0	Dismissal and disposal	pag.	36

1.0 GENERAL CHARACTERISTICS

Operator for swing gates up to 2.20 m per gate leaf, 230V A.C. powered, IP54 protection rating, fitted with:

- autoapprendimento del codice tra trasmettitore e ricevitore radio;
- self-learning of the code between transmitter and radio receiver;
- adjustable amperometric detector for movement inversion of the opening and closing gate leaves;
- colour-coded terminals to identify the various accessories and simplify connections;
- power up warning LEDs, programming and safety test;
- endstops for managing gate leaf stops when opening and slow-downs when closing;
- emergency release with customised key;
- power cable L = 2.5 m.

1.1 COMPONENT PARTS

- 1) Control panel
- 2) Gearmotor
- 3) Base bracket
- 4) Head brackets
- 5) Fixing nuts and screws
- 6) Transmission arms
- 7) Cable feedthroughs
- 8) Cable gland

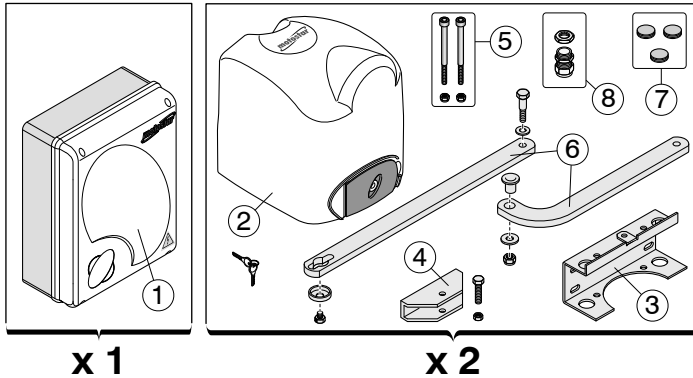

1.2 TECHNICAL CHARACTERISTICS

24V D.C. self-locking gearmotor, powered by a 230V A.C. control panel.

Power supply to control panel:

230V A.C. – 50/60Hz

Power supply to gearmotor:

24V D.C.

Max power: 140W

Nominal supply voltage: 5A max

Max thrust: 180N

Max frequency of use: 45 cycles/h

Duty cycle: 50%

Reduction ratio: 1/36

Operating temperature: from -20° to +55°C

Overall weight including packaging: 30 Kg

1.3 DIMENSIONS

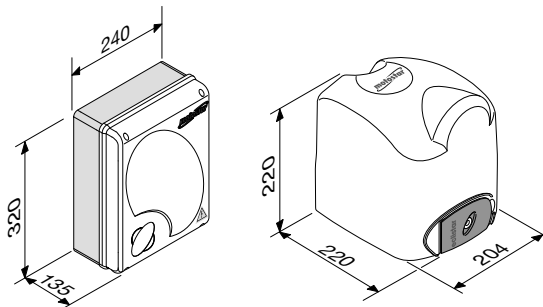

1.4 MAIN COMPONENT PARTS OF A STANDARD INSTALLATION

- 1) Flashing light with built-in antenna
- 2) Keypad selector
- 3) Control panel
- 4) Photocell
- 5) Junction box for passage of electrical cables
- 6) Gearmotors
- 7) Transmitters

*The standard installation shown is only an example.
Check the illustrations and the contents list in the kit box you
have purchased.*

Number of wires per cable section		
(A) + (B)		
(A)	Power supply	3 x 1,5
(B)	RX photocell	4 x 0,5
(C)	TX photocell	2 x 0,5
(D)	flashing light	2 x 1,5
(E)	gearmotor	3 x 1,5
(F)	antenna	RG58 cable

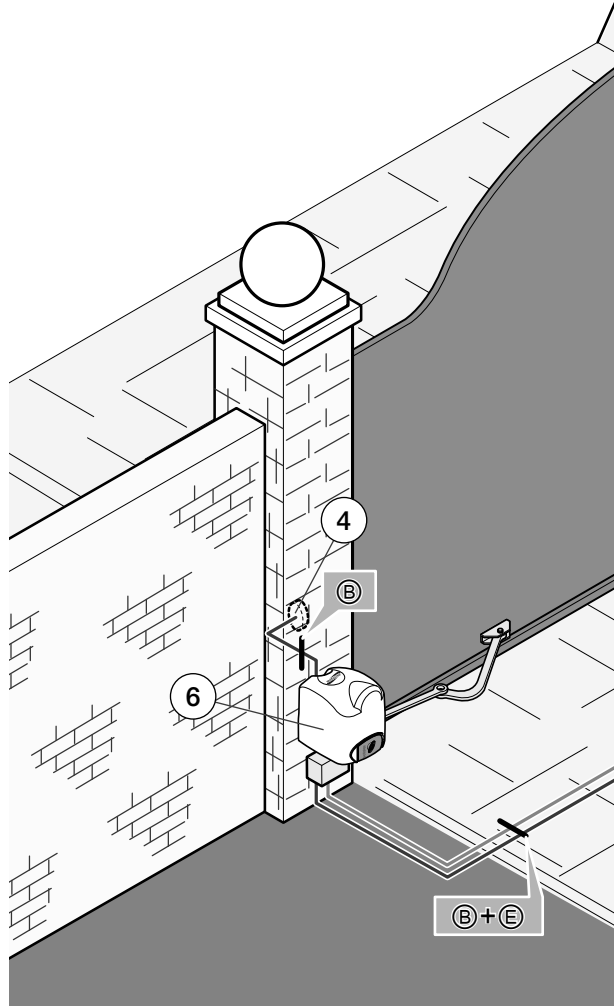

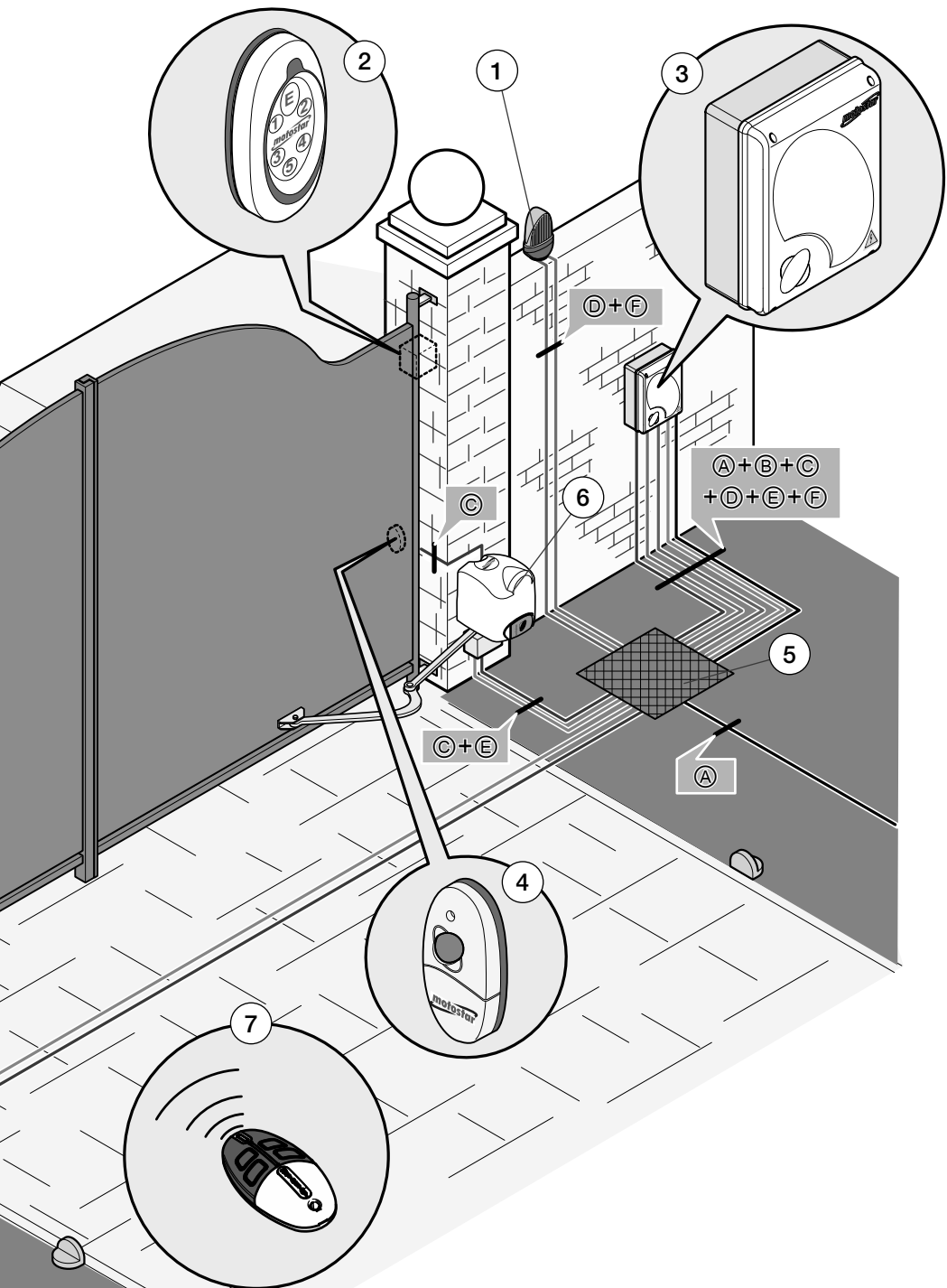

1.5 LIMITS TO USE

The maximum width of the gate leaf must not exceed 2.2 metres and its max weight cannot exceed 300 kg.

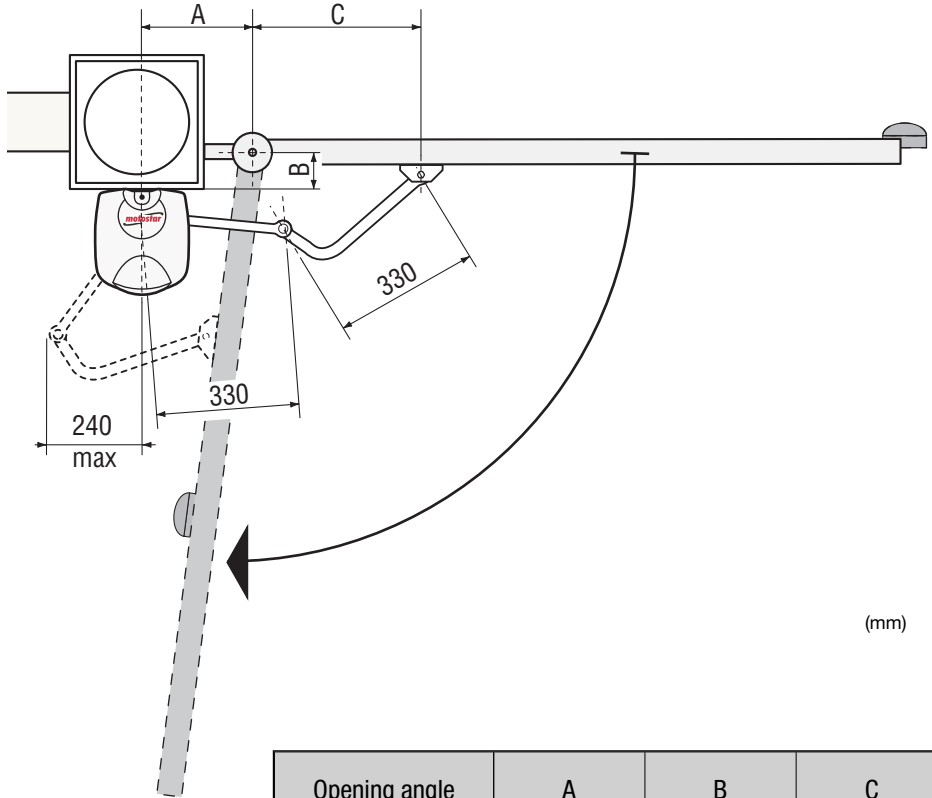

(mm)

Opening angle	A	B	C
90°	140÷205	0÷50	430
	140÷195	75÷100	430
	140÷185	125÷150	400
	140÷175	175÷200	400
110°	180÷210	0	430
	200÷205	50	430

GATE CHECKS BEFORE INSTALLING

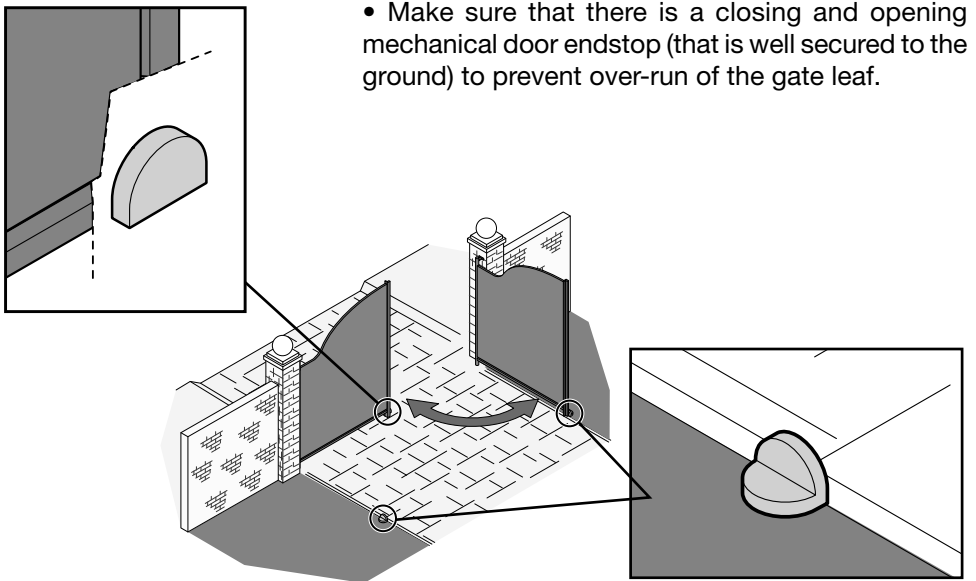
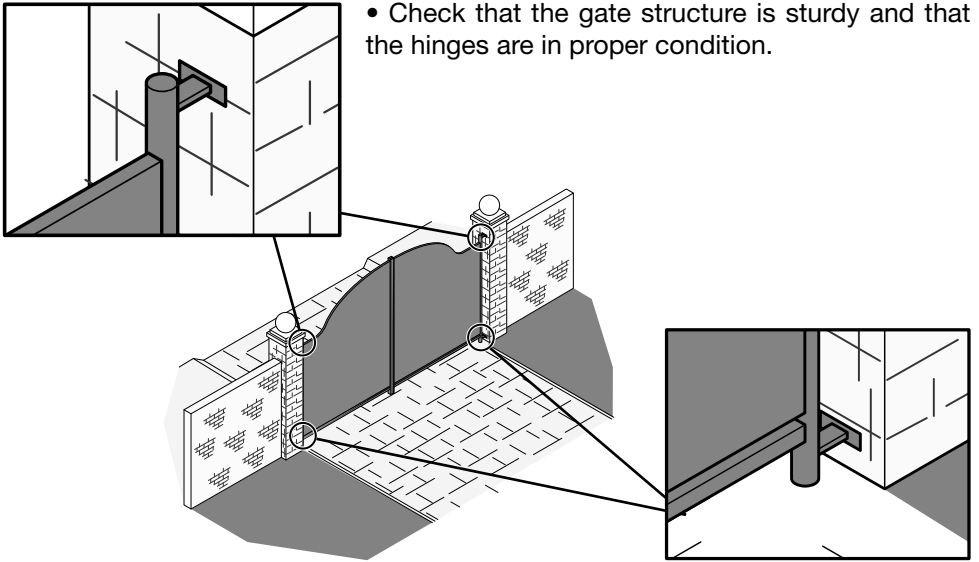

1 - Set up the tubes for the electrical connection and junction boxes.

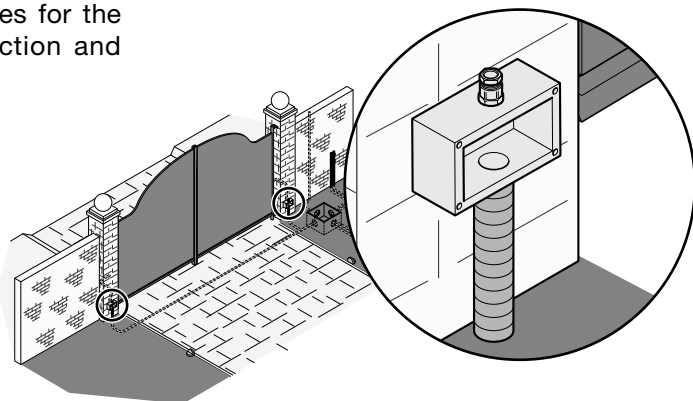

2 - Insert the electrical cables that come from the junction pit into the tubes, making sure the sections are right depending on the use to be made (see installation on page 4).

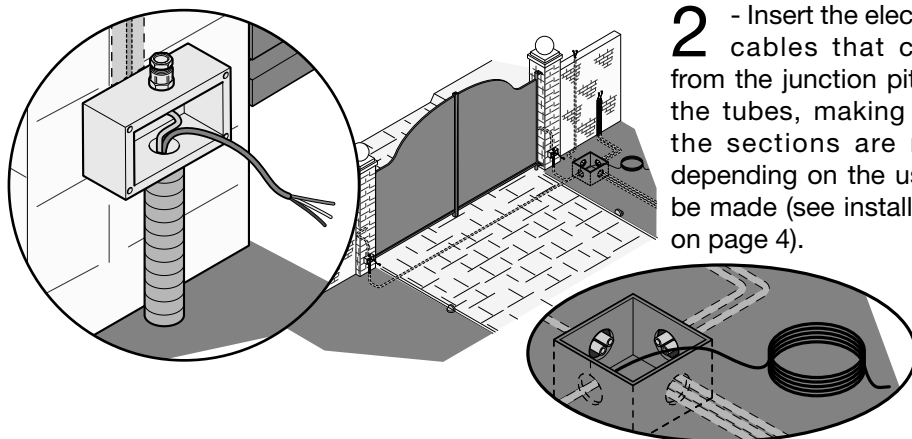

3 - Decide where to fix the head bracket. Position the base plate on the post, making sure the fixing and application measurements are right (see this drawing) (see page 6).

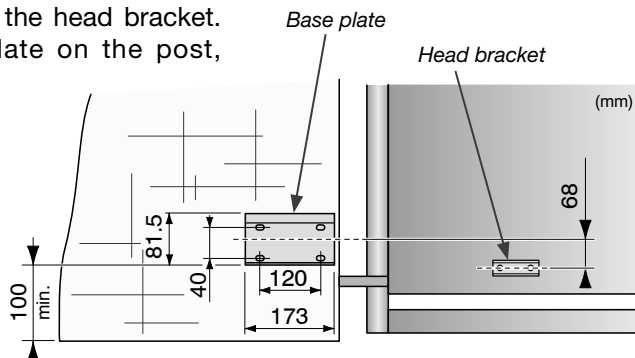

4 - Secure the base plate, using securing elements chosen according to the post type and materials.

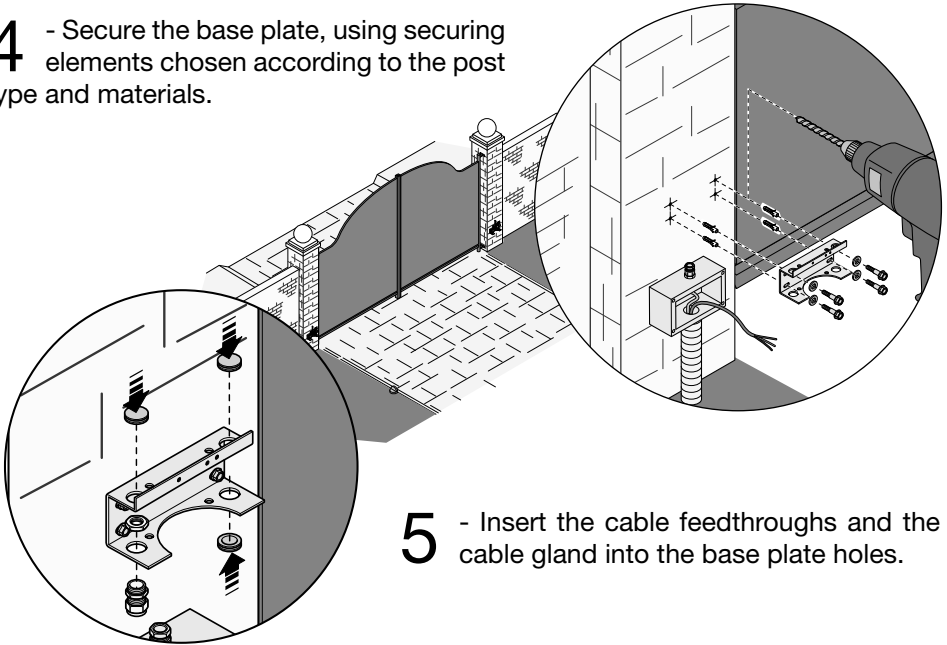

5 - Insert the cable feedthroughs and the cable gland into the base plate holes.

6 - Position the head bracket onto the gate leaf at a "C" distance from the axis of the hinge while taking into account the A and B measurements as shown in the table on page 6.

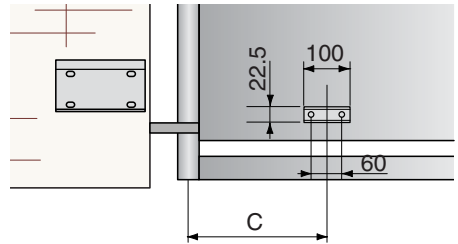

7 - Secure the bracket using securing elements chosen according to the gate type and materials.

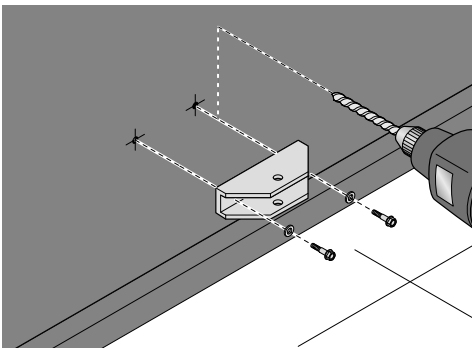

SECURING THE GEARMOTOR

1 - Remove the cover, insert the gearmotor into the base bracket so that it corresponds to the 4 holes and secure it using the supplied screws and nuts.

Warning: a sticker tag on the microswitch shows whether that gearmotor should be mounted to the right (DX) or to the left (SX).

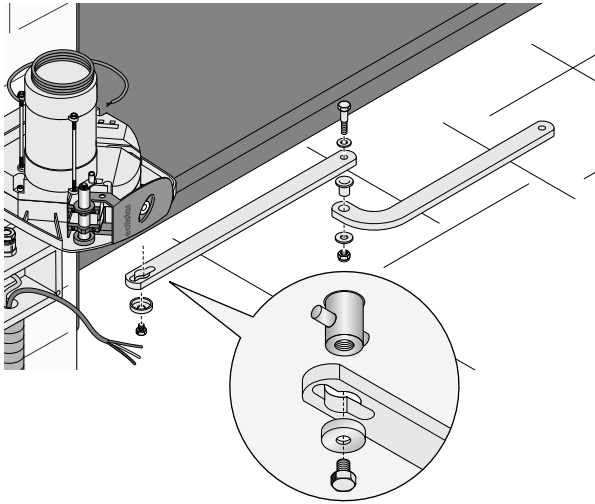
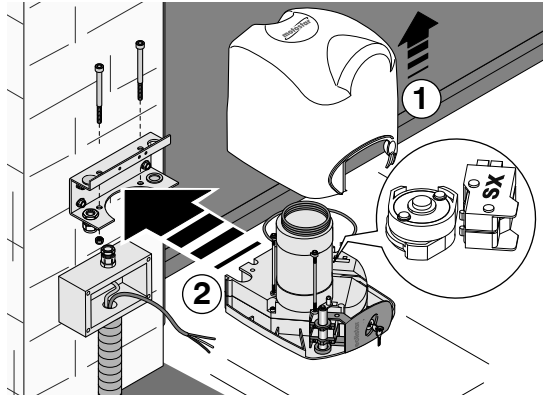

2 - Insert and secure the straight arm into the gearmotor shaft using plug, screw and relative bushing. Lubricate the bushing, insert it into the straight arm and join it to the curved arm using the supplied screw, the washers and nut.

3 - Release the gearmotor by opening the hatch (using the opposite key); to lock it, close the hatch.

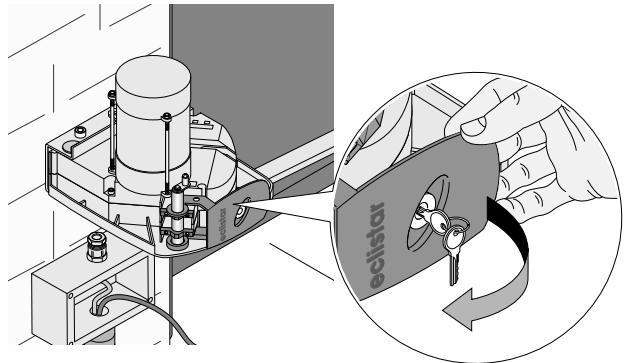

- 4** - Secure the curved arm to the head bracket using the supplied screw and nut. Lubricate it and check that the arm rotates freely.

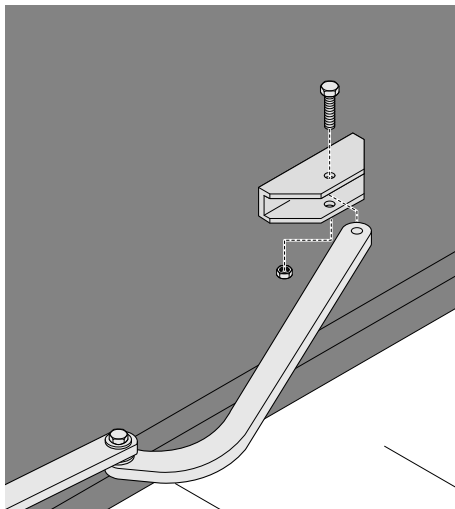

- 5** - Perforate the cable feedthrough to the base bracket on the side of the cable gland.

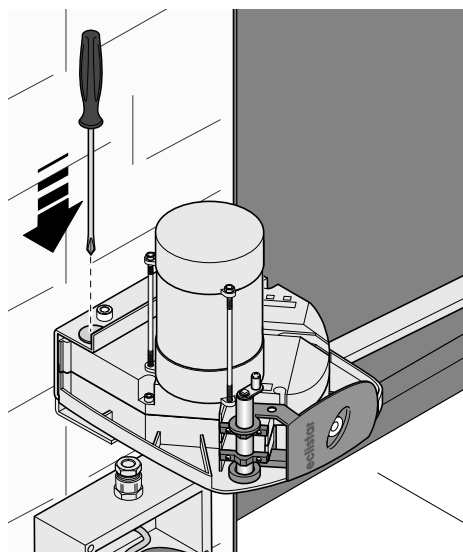

- 6** - Insert the cable into the cable gland and block it. Connect the gearmotor cables to the power cables coming from the control panel (see diagram on page 22).

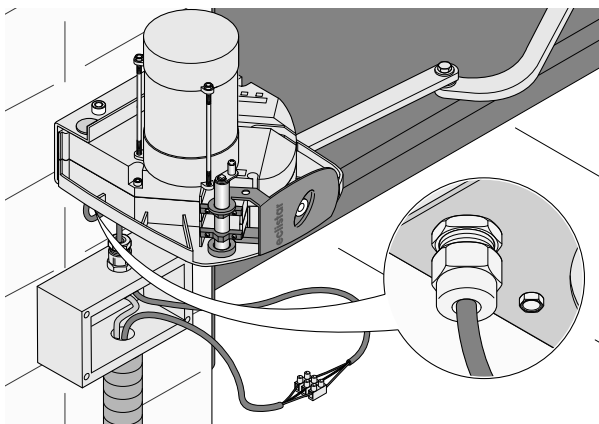

ADJUSTING THE ENDSTOPS

LEFT HAND GEARMOTOR

- INNER VIEW -

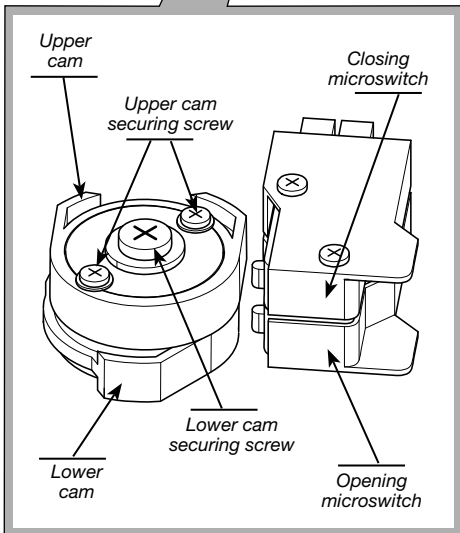
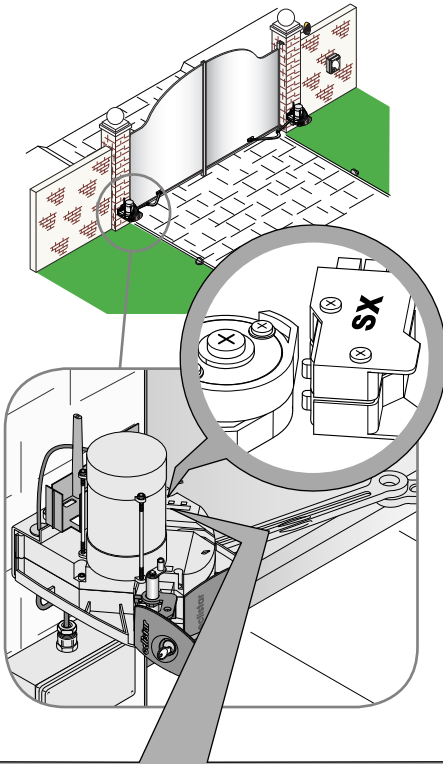

ADJUSTING THE OPENING ENDSTOP

- 1 - With the motor released, place the gate leaf at a distance of 5 cm from the opening endstop.

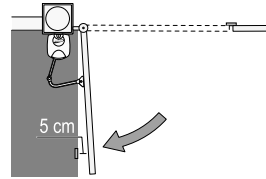

- 2 - Rotate the lower cam clockwise ...

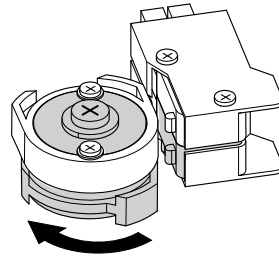

... until the microswitch is activated.

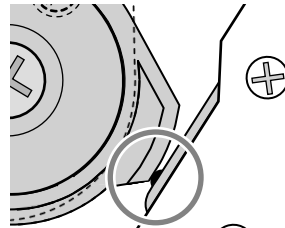

- 3 - Secure the cam using the central screw.

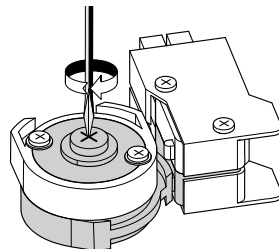

ADJUSTING THE ENDSTOPS

ADJUSTING THE CLOSING ENDSTOPS

N.B. Always adjust the opening endstop before adjusting the closing one.

Warning: the upper cam of the operator's endstop assembly is set up for gate leaf widths ranging from 1.20 m to 2.20 m.

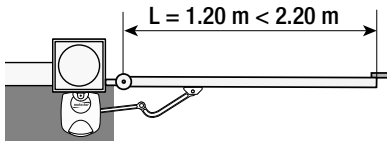

- 1 - Release the gearmotor and completely close the gate leaf.

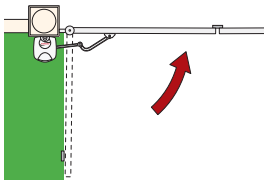

- 2 - Rotate the upper cam counter-clockwise

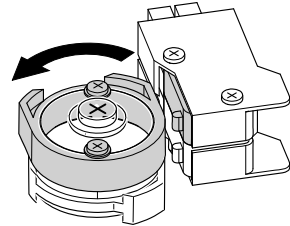

... until the switch of the micro is released.

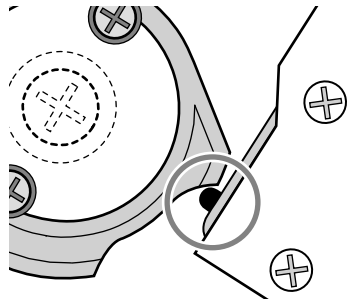

- 3 - Secure the cam using the lateral screws.

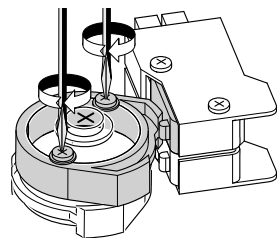

ADJUSTING THE ENDSTOPS

continue > adjusting the **left hand closing endstop**

N.B. If the gate leaf measures less than 1.20 metres ...

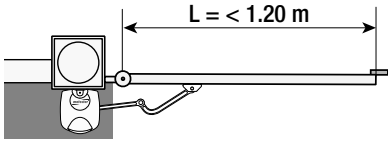

... turn the upper cam upside down and then adjust the endstop.

- 1** - Remove the securing screws from the upper cam.

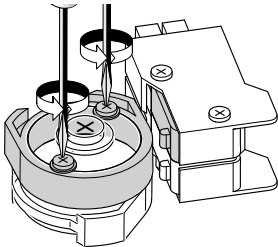

- 2** - Turn the cam upside down.

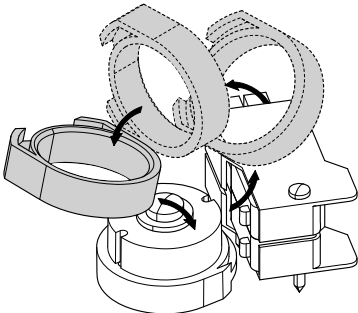

- 3** - Release the gearmotor and completely close the gate leaf.

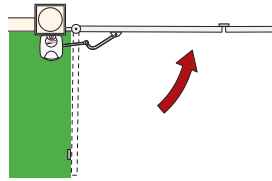

- 4** - Turn the upper cam counter-clockwise

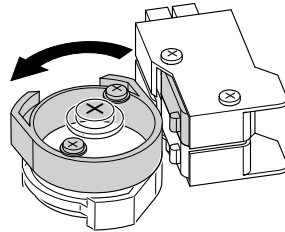

... until the switch of the micro is released.

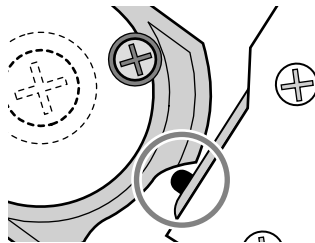

- 5** - Secure the cam using the lateral screws.

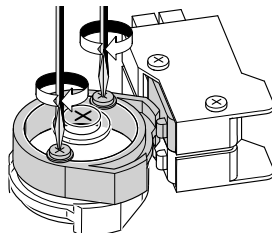

ADJUSTING THE ENDSTOPS

RIGHT HAND GERMOTOR

- INNER VIEW -

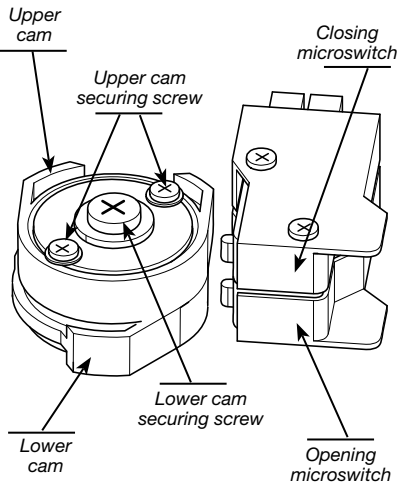
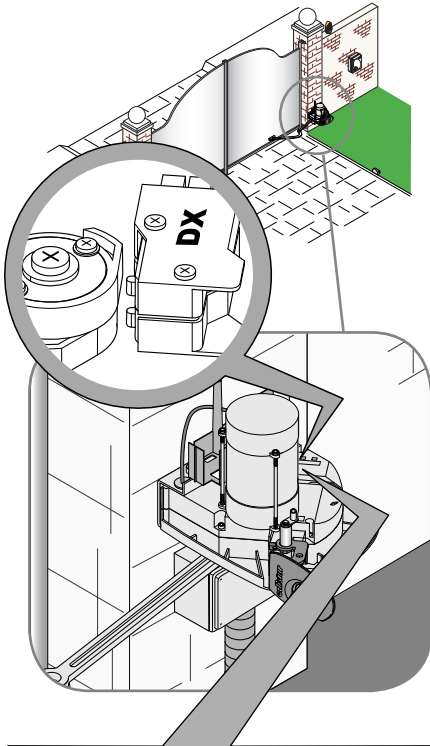

ADJUSTING THE OPENING ENDSTOP

- 1 - With the motor released, place the gate leaf at a distance of 5 cm from the opening endstop.

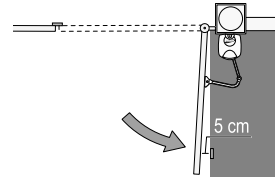

- 2 - Rotate the lower cam counter-clockwise ...

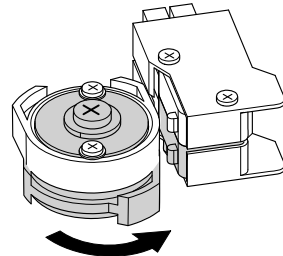

... until the switch of the micro is activated.

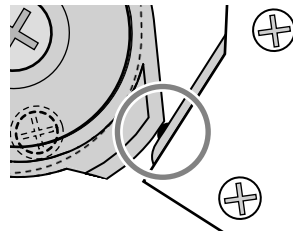

- 3 - Secure the cam using the central screw.

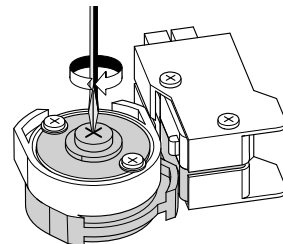

ADJUSTING THE ENDSTOPS

ADJUSTING THE **CLOSING** ENDSTOP

N.B. Always adjust the opening endstop before adjusting the closing one.

Warning: the upper cam of the operator's endstop assembly is set up for gate leaf widths ranging from 1.20 m to 2.20 m.

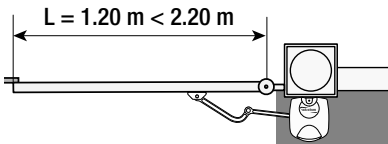

- 1** - Release the gearmotor and completely close the gate leaf.

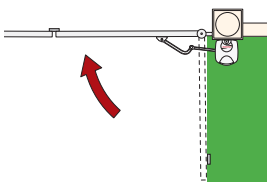

- 2** - Rotate the upper cam clockwise

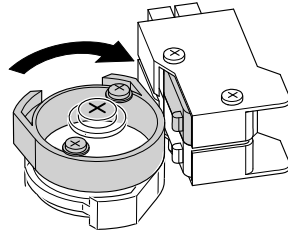

... until the switch of the micro is released.

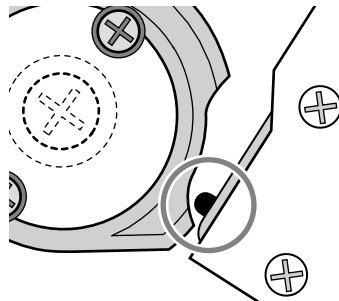

- 3** - Secure the cam using the lateral screws.

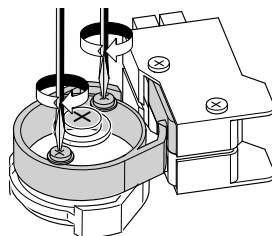

ADJUSTING THE ENDSTOPS

*continue > adjusts the **right hand closing** endstop*

N.B. If the gate leaf measure less than 1.2 metres ...

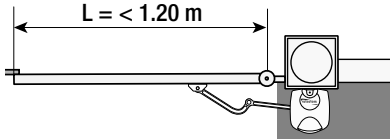

... turn the upper cam upside-down and then adjust the endstop.

- 1** - Remove the securing screws of the upper cam.

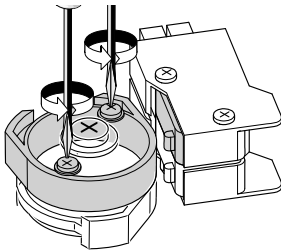

- 2** - Turn the cam upside down.

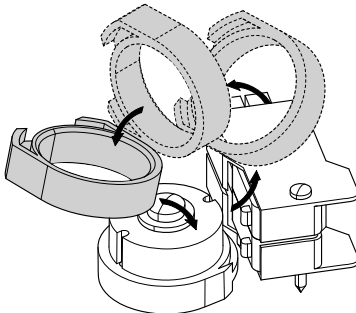

- 3** - Release the gearmotor and completely close the gate leaf.

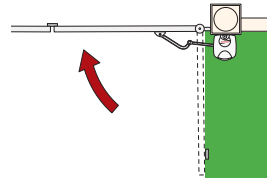

- 4** - turn the upper cam clockwise ...

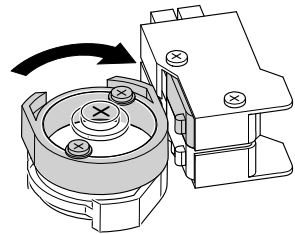

... until the switch of the micro is released.

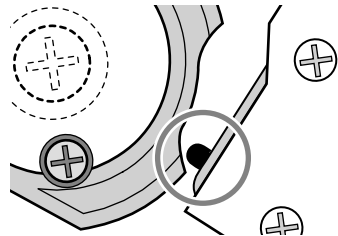

- 5** - Secure the cam using the lateral screws.

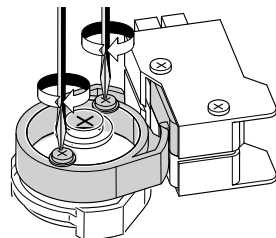

3.0 CONTROL PANEL

If The control panel is made up of a two-colour ABS casing, featuring a fully opening hatch which can be hinged either right or left. Inside, the control board featuring a receiver radio card and transformer.

We suggest installing it in an area protected from accidental impacts or possible tampering.

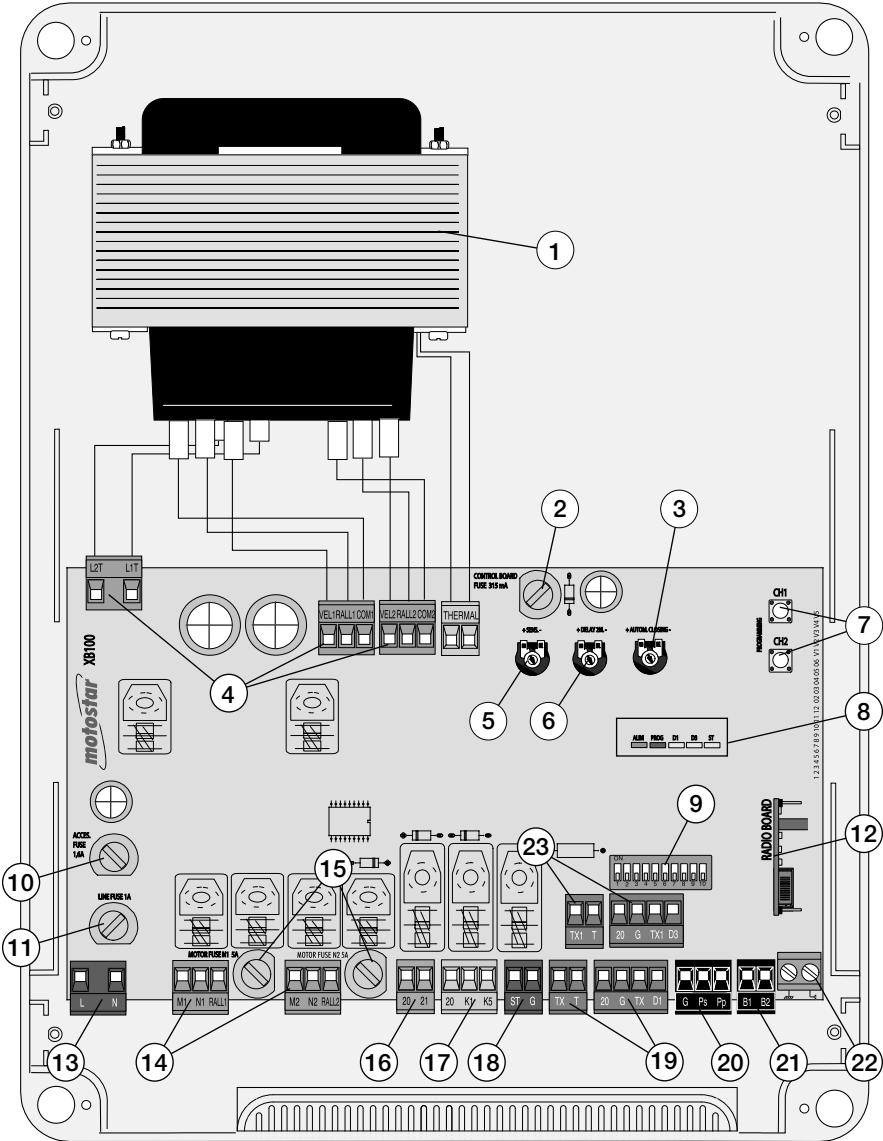

LEGEND

- | | |
|---|---|
| <p>1 - Transformer</p> <p>2 - Card fuse</p> <p>3 - Trimmer for adjusting automatic closing time</p> <p>4 - Terminals for connecting the transformer</p> <p>5 - Trimmer for adjusting the sensitivity of the obstacles</p> <p>6 - Trimmer for adjusting the closing time of the 2nd motor</p> <p>7 - Buttons for memorising the radio code</p> <p>8 - Function control LED</p> <p>9 - “Dip-switch” function selector</p> <p>10 - Accessories fuse</p> <p>11 - Line fuse</p> <p>12 - Radio Card</p> <p>13 - Terminals for connecting up 230V (A.C.) power</p> | <p>14 - Terminals for connecting up gearmotors</p> <p>15 - Motor fuse</p> <p>16 - Terminals for powering up accessories</p> <p>17 - Terminals for connecting up warning signal accessories</p> <p>18 - Terminals for connecting up the stop button</p> <p>19 - Terminals for connecting up the opening photocells</p> <p>20 - Terminals for connecting up the command buttons</p> <p>21 - Terminals with N.O. (B1-B2) output</p> <p>22 - Terminals for antenna fitted with RG58 cable</p> <p>23 - Terminals for connecting up the partial stop photocells</p> |
|---|---|

Protection rating against dust and liquids:

IP54

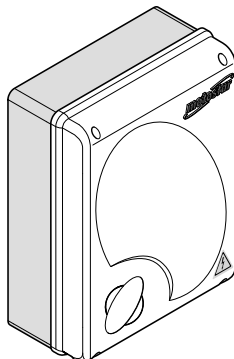

FUSE TABLE

pos.	to protect:	Fuses:
15	Motors	5A-F
11	Control board (line)	1.6A-F
10	Accessories	1A-F
2	Command devices (card)	315mA-F

3.1 ASSEMBLING AND SECURING THE CASING

Before securing the casing to the wall, you need to assemble and mount the hinges on the side you prefer.

(N.B. you may also just wish to secure the cover using the 4 screws).

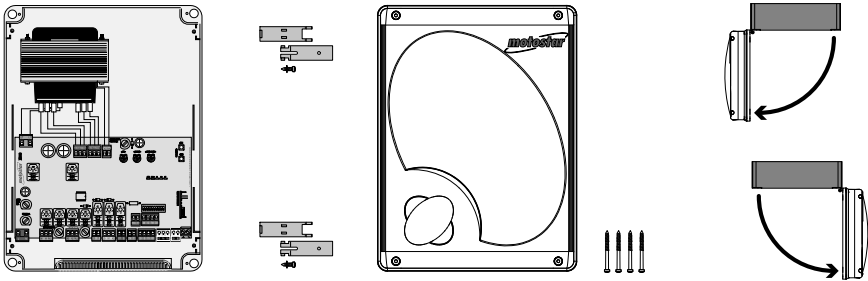

1 - Assemble the pressure hinges.

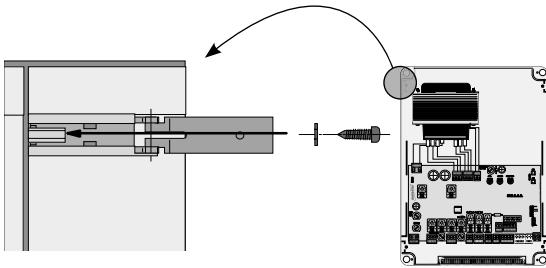
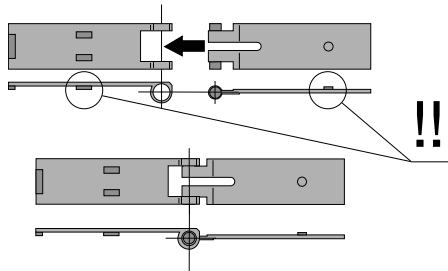

2 - Insert the hinges into the base of the casing (either right or left, as you prefer) and secure them using the supplied screws and washers.

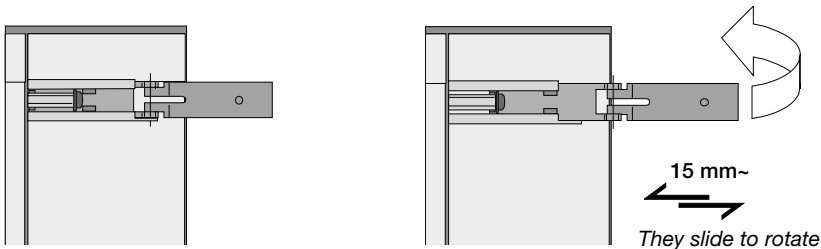

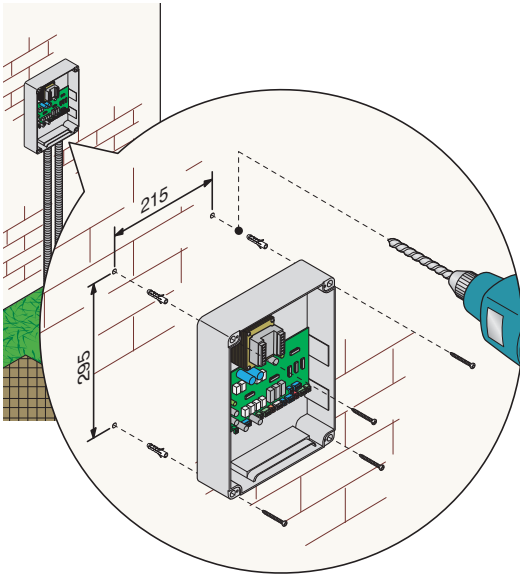

3 - Position and secure the base of the casing using securing elements suitable to the structure and surface to which you will be securing.

4 - Insert the tubes and cable glands (not supplied) under the base of the container, removing the existing cable feedthroughs.

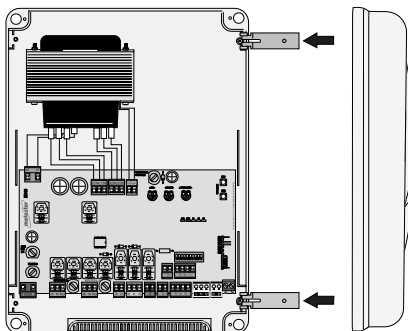
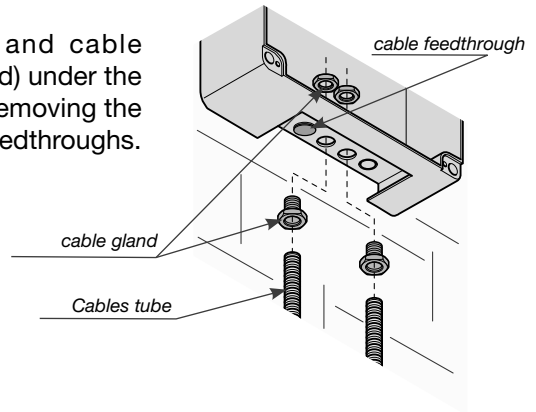

5 - Snap the cover into the hinges.

N.B. You can also do this at the end, after you have connected everything.

3.2 CONTROL BOARD AND ITS FUNCTIONS – DESCRIPTION

The control panel should be powered with 230V A.C., with max 50/60Hz frequency.

The command devices and accessories are rated at 24V (N.B. The overall power draw from the connected accessories must not exceed 37W).

The card is fitted with an amperometric device which constantly monitors the motor's thrust rate.

When the gate runs into an obstacle, the amperometric sensor detects an overload in the thrust and causes the gate to invert its direction of travel:

- it reopens it when it is closing ⁽¹⁾;

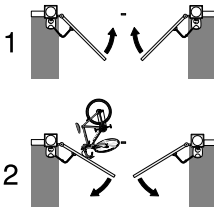

- it recloses it when it is opening.

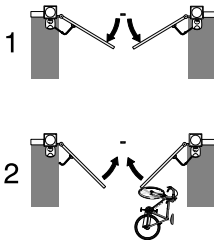

⁽¹⁾ *Warning: in this case, after 3 consecutive obstacle detections, the gate stays open and automatic closing is excluded; for movement to resume, you must first press the command button or use the transmitter.*

All the connections are protected by fast (F) fuses, see table on page 19.

The card provides and controls the following functions:

- automatic closing following an opening command;
- pre-flashing by the flashing light;
- obstacle detection when gate is stopped at any point;
- continuous monitoring of photocell operation.

The command mode that can be defined are:

- opening/closing;
- opening/closing in maintained action mode;
- pedestrian opening;
- total stop.

Once the photocells have detected an obstacle, they may trigger, depending on the connection mode:

- gate reopening if gate is closing;
- a temporary stop.

The opposite trimmers adjust:

- the automatic closing time span;
- a delay in the M2 gearmotor closing ;
- the amperometric device's detection sensitivity;



Warning! Before acting inside the equipment, cut off the main power and disconnect the batteries (if inserted).

3.3 ELECTRICAL CONNECTIONS

GEARMOTORS, TRANSFORMER AND POWER SUPPLY

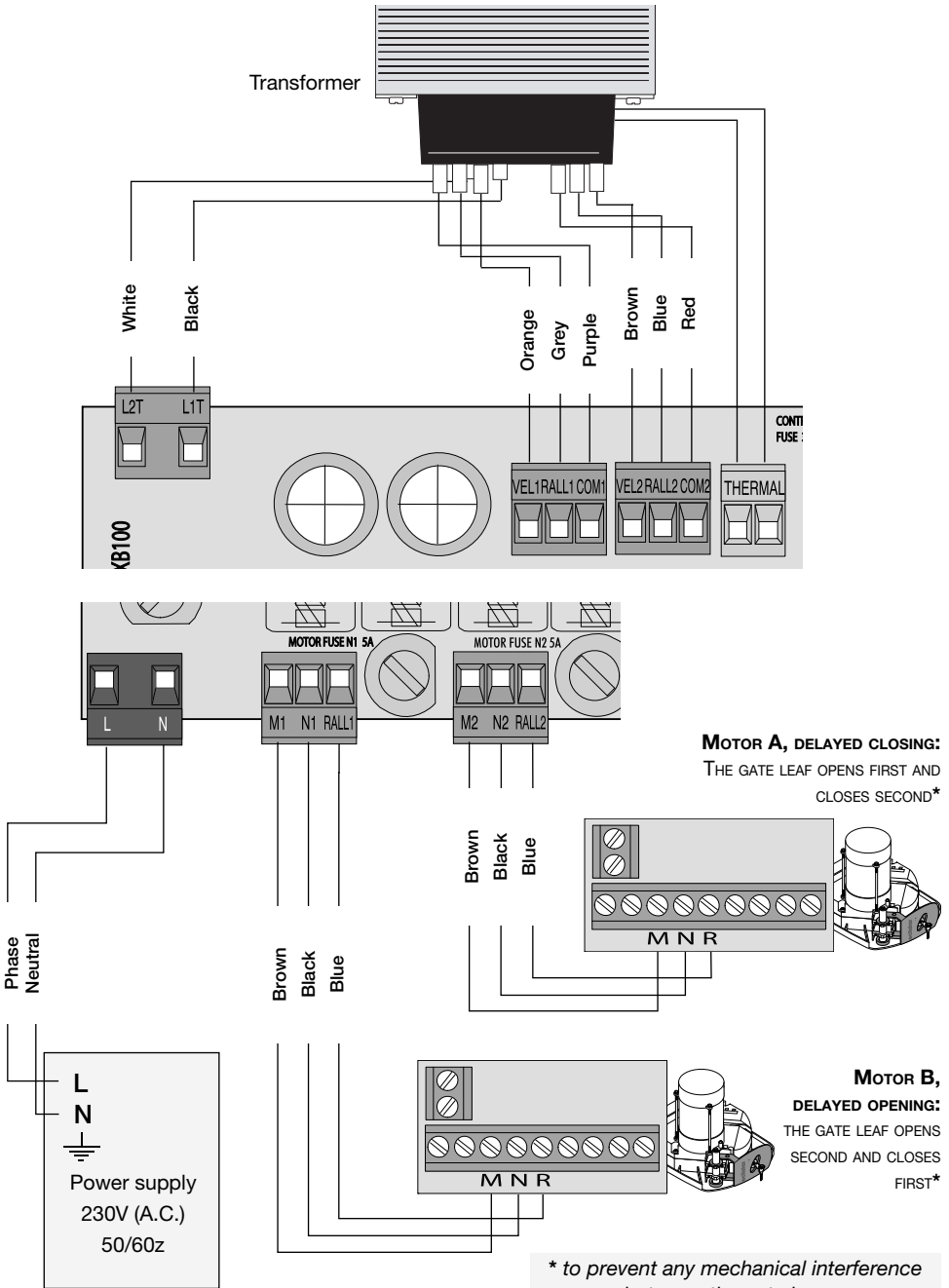

COMMAND DEVICES

N.C. contact for **STOP** buttons
(*remove the bridge wire*).

- Stops the gate while excluding the automatic closing cycle. To resume movement press the command or transmitter button.

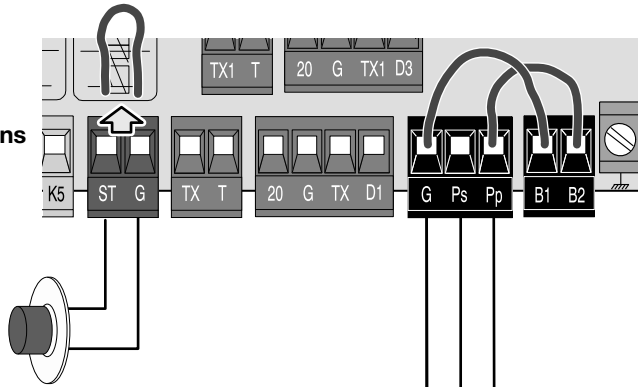

N.O. contact for **Command button**, for
A) Opening and Closing the gate (see dip switch 2 for which mode) ...
... or, with dip switch 6 ON, for
B) Closing in Maintained Action mode.

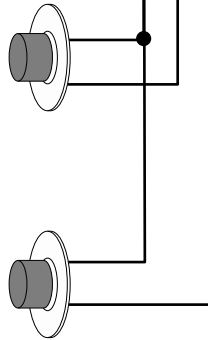

N.O. contact for **Command buttons**, for
C) Pedestrian Opening (opens only one gate leaf for persons to pass) ...
... or, with dip switch 6 ON, for
D) Opening in Maintained Action Mode.

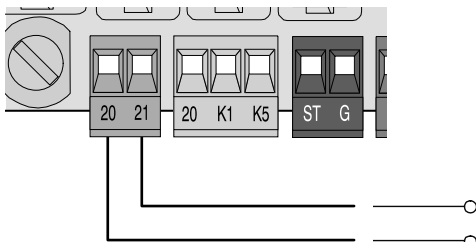
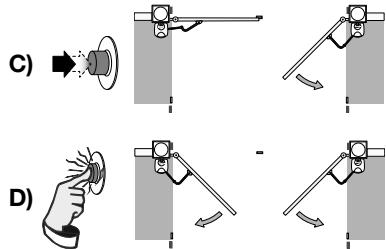
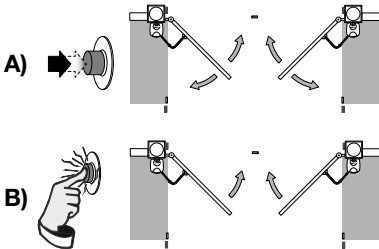

Terminals for powering up 24V a.c./d.c. accessories, for a max total of 4W.

WARNING AND LIGHTING DEVICES

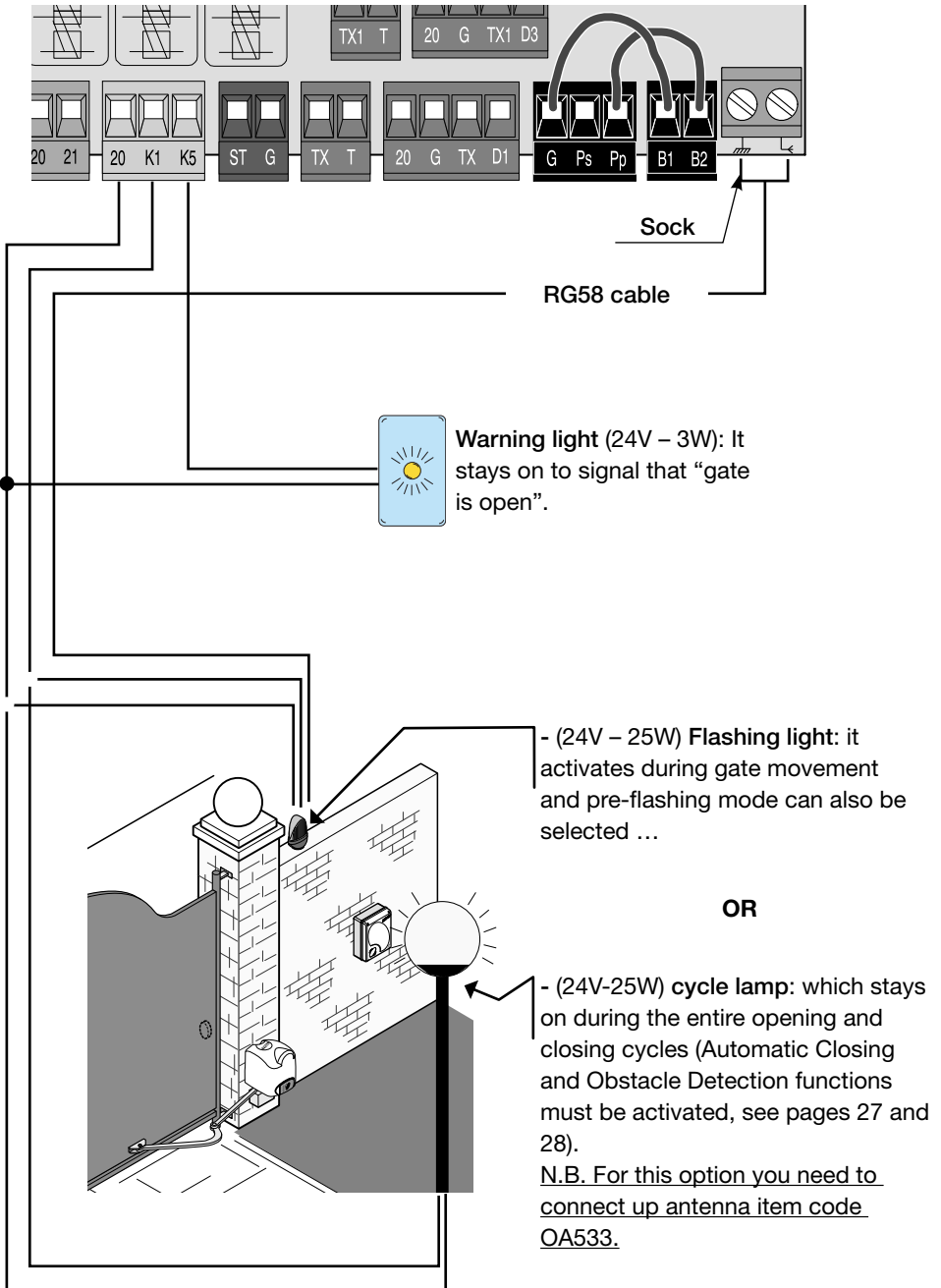

SAFETY DEVICES: PHOTOCELLS

How to connect up a pair of photocells to obtain **gate REOPENING**, when they detect an obstacle **during closing phase**.
Dip **switch 7** must also be placed **to OFF**.

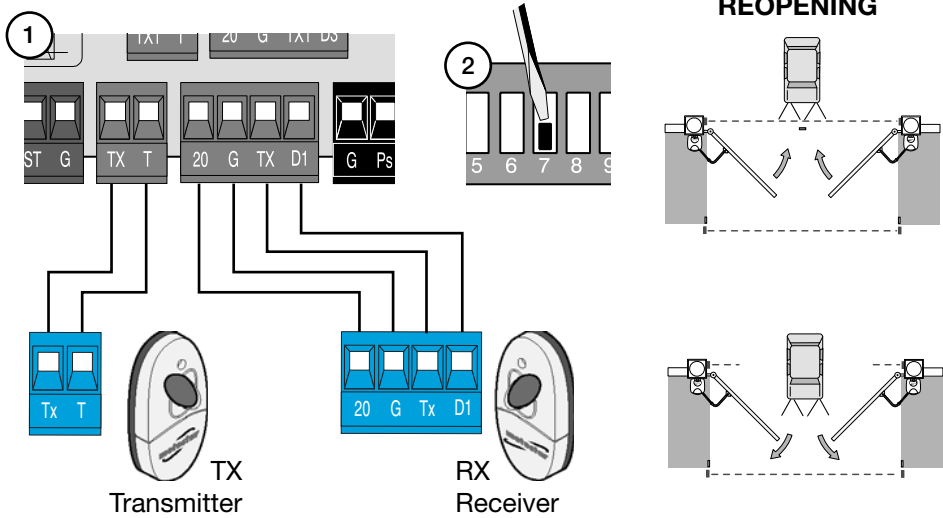

How to connect up a pair of photocells (or a 2nd pair) to obtain **temporary gate STOP**, when they detect an obstacle **during movement**.
Dip **switch 8** must also be placed **on OFF**.

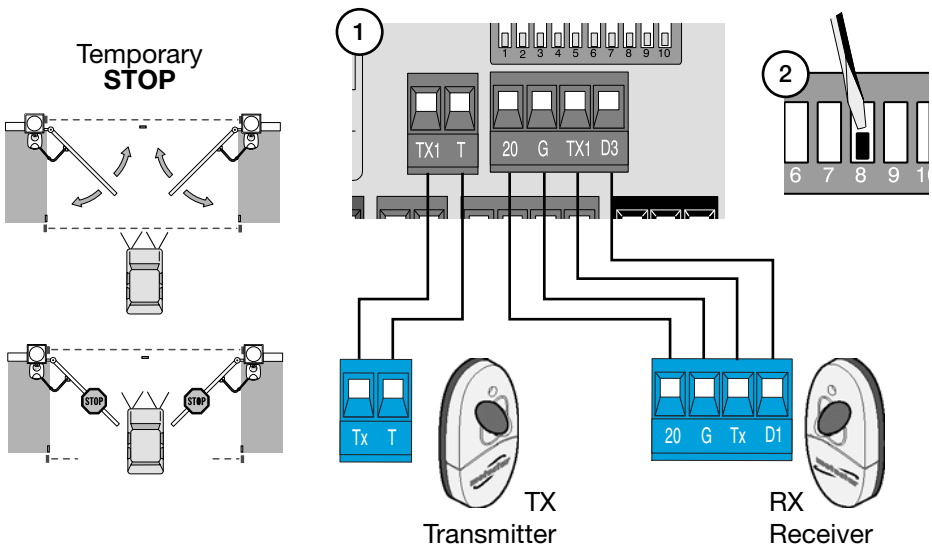

3.4 FUNCTION SELECTION

Select the functions by positioning the dip switches to ON or OFF, using a screw driver as shown in the picture.

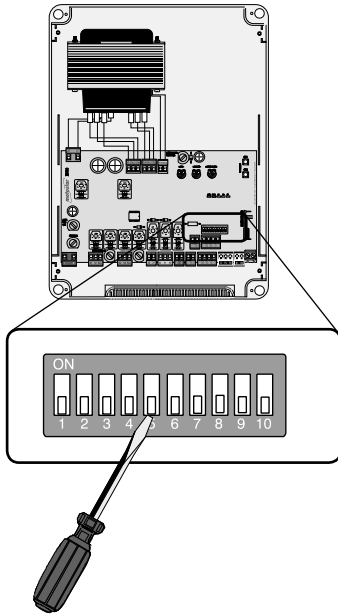

AUTOMATIC CLOSING 1 ON



The gate closes automatically after a set time interval from the complete opening; to adjust it, act on the trimmer described on page 29.

Automatic closing may be interrupted by a command from a button, by the transmitter or by the action of the photocells.

This function deactivates anyhow after a STOP action or when the power is out.

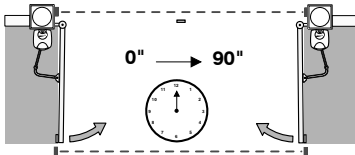

SEQUENTIAL COMMAND 2 ON + 3 OFF



By pressing the button connected on G-Ps or that on the transmitter, the command sequence will be Open-Stop-Close-Stop.

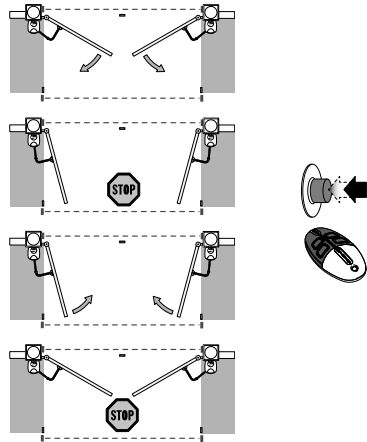

STEP/STEP COMMAND 2 OFF + 3 OFF



By pressing the button connected on G-Ps or that on the transmitter, the command sequence will be Open-Close.

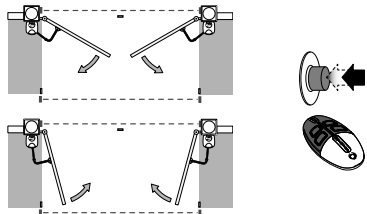

OPEN ONLY COMMAND 2 ON/OFF + 3 ON



Independently of the button, the transmitter only commands the gate opening .

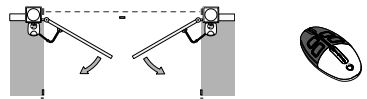

PRE-FLASHING
4 ON



The (Lumistar) flashing light connected on 20-K1, flashes 5 seconds before allowing any opening or closing action.

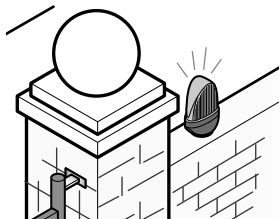

OBSTACLE DETECTION
5 ON



Even when gate is closed, open or closed due to a Total Stop (from button connected on St-G), if the safety devices (i.e. the photocells) detect an obstacle, this function blocks any command.

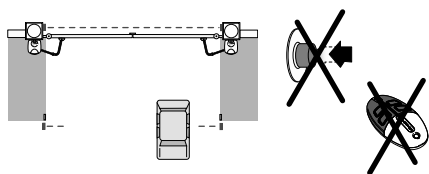

MAINTAINED ACTION
6 ON



The opening or closing command (see page 24), will have effect only by keeping the button pressed. Once released, the movement stops.

Also, this function excludes use of the transmitter.

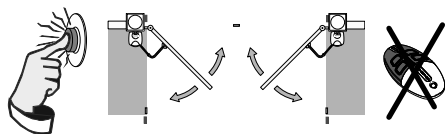

REOPENING
7 OFF



When detecting an obstacle during closing, the photocells trigger the gate to reopen (see page 26).

If there are no photocells or other safety devices connected, leave the dip switches ON.

TEMPORARY STOP
8 OFF



When detecting an obstacle during movement, the photocells trigger the gate to stop (see page 26).

If there are no photocells or other safety devices connected, leave the dip switches ON.

Press the button or use the transmitter for the gate to move again. If you have also selected automatic closing (dip switch 1 ON), the gate will reclose once the set time interval has elapsed.

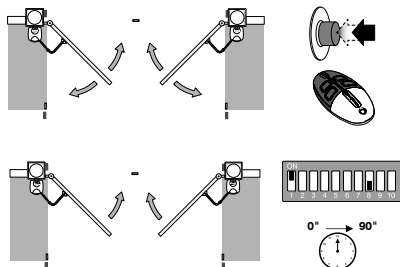

PHOTOCELLS TEST
9 ON



At each opening or closing command, whether from button or transmitter, the control panel will check the efficiency of the photocells before initiating any action.

Dip switch 10 not in use:
Keep it in the OFF position!

3.5 ADJUSTING FUNCTIONS

To adjust the trimmers, use a small screw driver by turning it clockwise (+) to increase or counter-clockwise (-) to reduce.

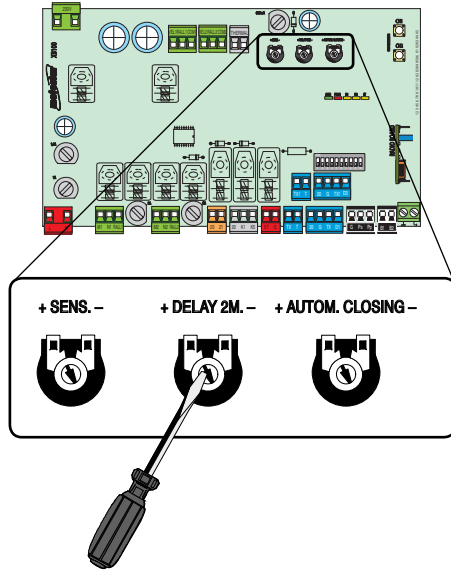

DELAY 2M

This adjusts the delay time for the closing of the A motor (see page 23) from 0 to 15 seconds. We suggest adjusting it so that the closing arrival distance from motor B, is about 50 cm.

If you use a button for the pedestrian opening mode (see page 24), consider that this distance is also the opening width for pedestrian passage.

AUTOM. CLOSING

It adjusts the automatic closing action time (see page 27) from 0 to 90 seconds.

SENS.

This adjusts the sensitivity of the amperometric sensor, see page 22.

Increase the sensitivity to detect different kinds of obstacles, or ones of different sizes.

3.6 CHECKING SETTINGS OF ENDSTOP ASSEMBLY



Make sure you have secured the area in which you are working (i.e. loose cable ends or live wires, equipment that may interfere with the movement of the structures, unauthorised personnel or children), and then power up the system.

Check endstop setting, which was made when gearmotor was installed (page 12 to 17), making sure whether the gate leaves reach the desired maximum opening point. If necessary, repeat the setting by adjusting the position of stops or cams.

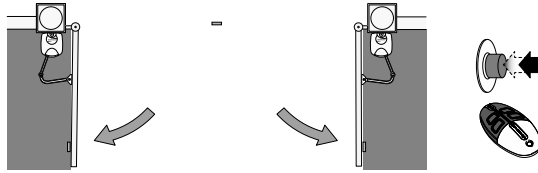

At this point, command a gate closing action,

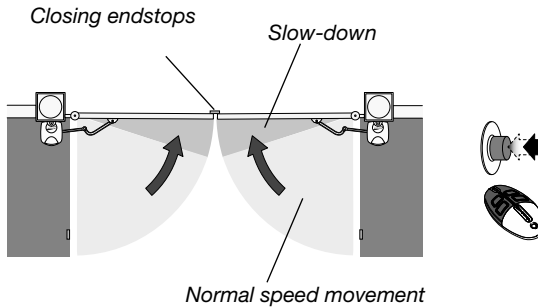

If the gate, instead of stopping closed, inverts its movement and reopens, repeat the setting leaving a bit more space between the cams and the switch.

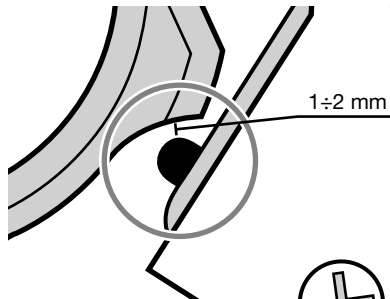

3.7 PROGRAMMING THE RADIO CODE

If replacing the control board or the radio card, you need to memorise the radio codes again, as explained below.

Inserting the radio card

You **MUST** insert it when the main power is off, because the control board will recognise it only when the it is powered up.

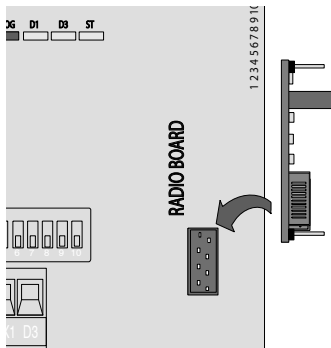

... now, with a transmitter button send the radio code: the LED will stay on to indicate the code has been memorised.

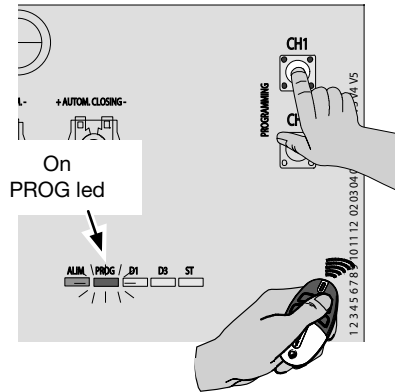

Duplicating transmitters

Clickstar is already coded. To add transmitter to those already supplied, follow this duplication procedure:

- 1 - press the first two button simultaneously until the LED flashes quicker;
- 2 - now press the button to be activated (the LED will come ON);
- 3 - within 10 seconds, rest the active transmitter against its back part and press down on the button to be duplicated.

After saving, the LED will flash 3 times and transmitter will be ready to use.

If necessary, repeat steps 1, 2 and 3 for the other buttons.

Memorising the code

Keep the "CH1" button pressed on the control board: the signalling led starts flashing ...

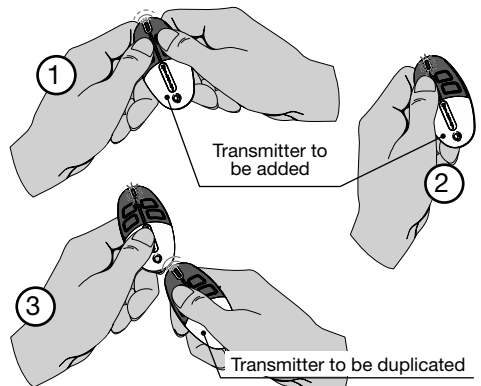
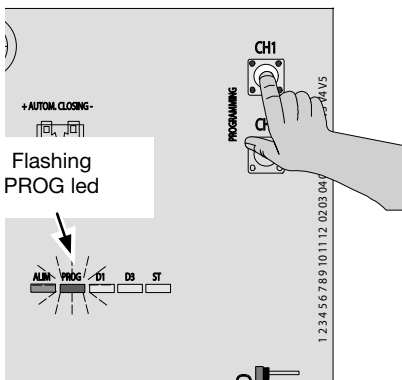

3.8 LED CONTROL FUNCTIONS

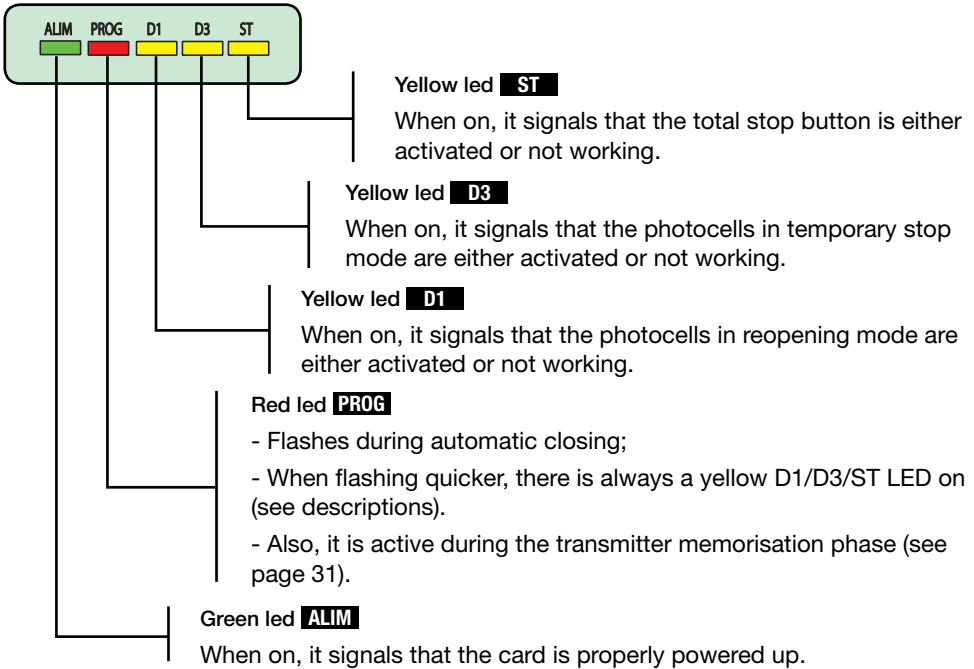

3.9 FINAL OPERATIONS

- Insert and secure the protective cover on both gearmotors.
- Close the control panel using the supplied screws.

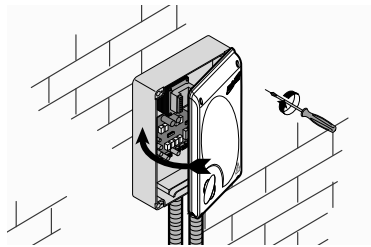
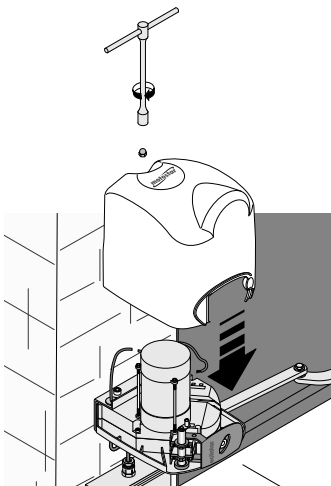

- Perform a general inspection of the system, testing all of the installed components. To this end, also read through the following chapters.

Once finished, store this documentation and that pertaining to any accessories, in a safe place for future consultation and use (i.e. maintenance).

4.0 WARNINGS AND PRECAUTIONS

• Do not use this operator and any relative accessories for uses other than those for which they were designed: the automatic opening and closing of swing gate within the limits and modes described in this manual. Motostar cannot be held liable for any damage caused from wrongful, erroneous or unreasonable use.

• Avoid working near the hinges or any mechanical moving parts. Do not enter the operating range of the operator when it is moving.

• Do not counter the force of the operator, as this can lead to hazardous situations.

• Do not allow children to play or loiter within the operating range of the operator.

• Keep transmitters or any other command devices (i.e. buttons) away from children, to prevent the operator from being activated by mistake.

• Immediately stop using the operator if any anomalous behaviour is manifested and then contact TECHNICAL ASSISTANCE.

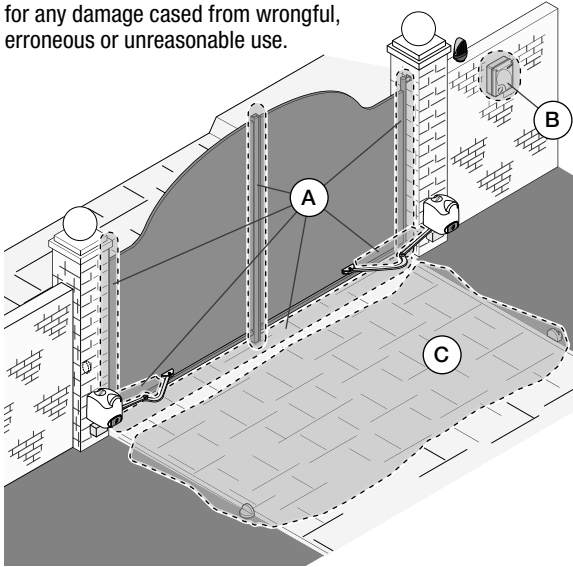

A - Danger – hand or feet could be crushed, trapped or sheared



B - Danger of 230V electrical shock



C - Gate action area

5.0 TROUBLESHOOTING

SYMPTOM	THIS COULD BE DUE TO	WHAT TO DO
- The gate neither opens nor closes	<ul style="list-style-type: none"> • No main power supply • The gearmotor is released • The transmitter battery is flat • The photocells are continuously engaged • The command devices (i.e. buttons or key switches) may be stuck or broken 	<ul style="list-style-type: none"> • Check the connections and general switches • Close the hatch (page 10) • Replace the batteries • Clean the front pieces and check the connections • Check the command devices
- The gate opens but won't close	<ul style="list-style-type: none"> • The photocell remains engaged 	<ul style="list-style-type: none"> • Clean the front pieces and check the connections
- The flashing light does not work	<ul style="list-style-type: none"> • The light bulb is burned 	<ul style="list-style-type: none"> • Replace it

For all other cases, or if proposed actions have not yielded the desired effect, contact TECHNICAL ASSISTANCE on the number shown at the bottom of the last page.

PERIODIC MAINTENANCE

The periodic maintenance action which you may carry out, that do not require any particular prescriptions, are:

- visual inspections of the gate structure, especially of the hinges and opening and closing endstops;
- inspection of the operator's area of movement, removing any vegetation that may have grown impeding the photocells to work properly;
- inspection of the functions of all of the connected devices, making sure they respond to the selections and functioning modes chosen when installed;
- cleaning of the photocells' front pieces, using a water-moistened rag (do not use solvents or other chemical agents).

After disconnecting the main power supply (from the general panel or sectional switch, if present) you may:

- remove the gearmotor cover, visually inspect the integrity of the connections and clean and visible devices;

Also do the same with the command panel after opening the small inspection door;

- check that all screws are tight in all of the different devices; lubricate any rotating parts and joints as well as the gate hinges.

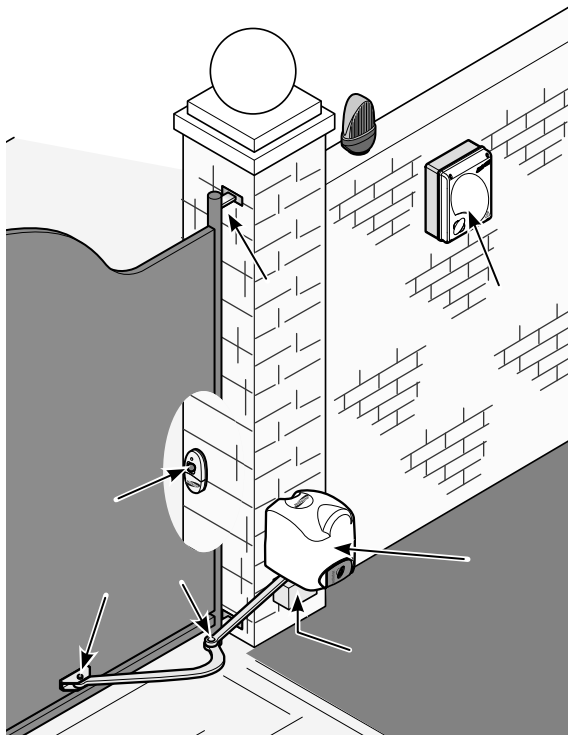

7.0 DISMISSAL AND DISPOSAL



The equipment and packing are made up of many different types of materials, the majority of which (i.e. paper, plastic, etc.) are treated as solid urban waste and recycled as such after proper selection.



The batteries, electronic cards and all those materials that may contain dangerous substances, must be turned over to specialised local firms for proper disposal.

Always check the pertinent laws in the country where the equipment is being used.

DO NOT DISPOSE OF IN THE ENVIRONMENT!

MANUFACTURER'S STATEMENT

Pursuant to attachment II B of Machine Directive 98/37/CE

The manufacturer

CAME Cancelli Automatici S.p.A.
internet: www.came.it - e-mail: info@came.it

Declares that the products hereto

ECLISTAR

Comply with the applicable parts of Directives

98/37/CE - MACHINE DIRECTIVE
2006/95/CE - LOW VOLTAGE DIRECTIVE
89/106/CEE - CONSTRUCTION MATERIALS DIRECTIVE
2004/108/CE - ELECTROMAGNETIC COMPATIBILITY DIRECTIVE
1999/5/CE - R&TTE DIRECTIVE

and of Laws

EN 12978
EN 13241-1
EN 60335-1
EN 60950-1
EN 61000-6-2
EN 61000-6-3
ETSI 300 220-3
ETSI 301 489-1

The Managing Director

Gianni Michielan

A handwritten signature in black ink, appearing to read 'Gianni Michielan'.

The original copy of the statement is on file and available upon request.

CAME UNITED KINGDOM Ltd

Unit 3 Orchard Business Park
Town Street - Sandiacre
Nottingham Ng10 5du - Great Britain
Tel. +44 115 9210430 - Fax +44 115 9210431

The logo for 'motostar' in a bold, red, italicized sans-serif font, with a black swoosh underline that loops around the 'o' and 'a'.

These instruction illustrate and describe one or more typical installations. For specific applications, which are not mentioned herein, our technicians are available to advise you.